

159 Gerrard Street East – Unit 2 Parking Directions

Contact

If you need help finding the parking spot please call or text: +1 647 268 9308.

Location

The parking spot is located at the back of the building and is accessible by Glenholme Pl

Google Maps Link

The link for Google Maps is below:

https://maps.app.goo.gl/ESNPntn4eSpM1wA3A?g_st=ic

Google Maps Plus Code

If the above link is not working, please go into Google Maps and search for the following plus code: MJ6G+58C Toronto, Ontario

Directions to the Parking Spot

1. Drive to 118 Pembroke Street and Turn right onto the Laneway (Glenholme Pl)



2. Drive through the Laneway until you reach the speed bump sign



3. Turn right at the speed bump sign



4. The parking lot is on the right. Your spot is #1 shown below. Enter the building through the back door shown below.



5. Unlock the door

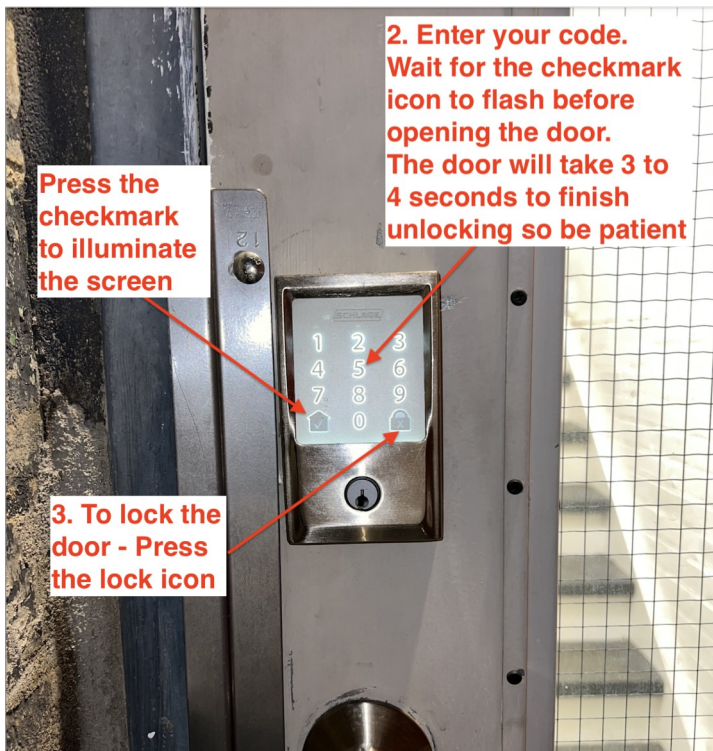

1. Press the Checkmark icon to illuminate the screen
2. Enter your 4 digit code. Wait for the Checkmark icon to flash before opening the door. The door will take 3 to 4 seconds to finish unlocking so be patient.
3. To lock the door when leaving Press the Home Icon

6. Walk up the steps



7. Continue until you reach unit 2

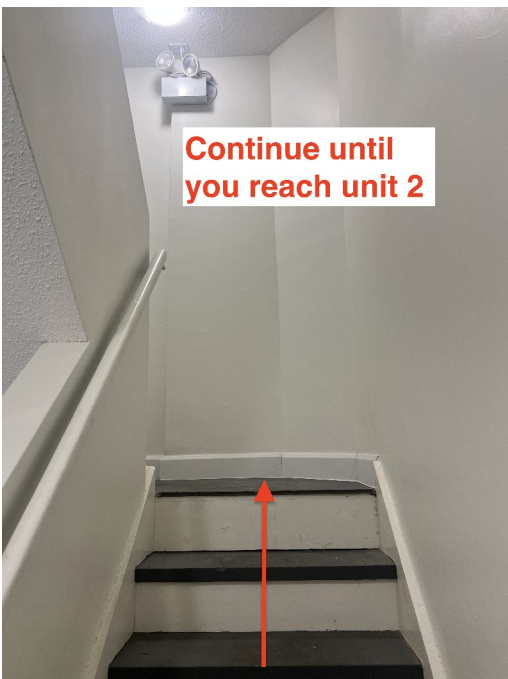

8. The apartment is unit 2

